

SECTION 9 WOODLAND ROAD & FORESTER ROAD

SUMMARY OF PROPOSED IMPROVEMENTS

Gate of the Gnoll Gatehouse to be opened to allow disabled access.
 Shared use path alongside Woodland Road to link to rear entrance of school.
 Removal of parking along Woodland Road.
 On road cycling on Forester road – quiet street.



- KEY**
- EXISTING CARRIAGEWAY
 - EXISTING FOOTWAY
 - PROPOSED FOOTWAY WIDENING TO CREATE SHARED USE PATH

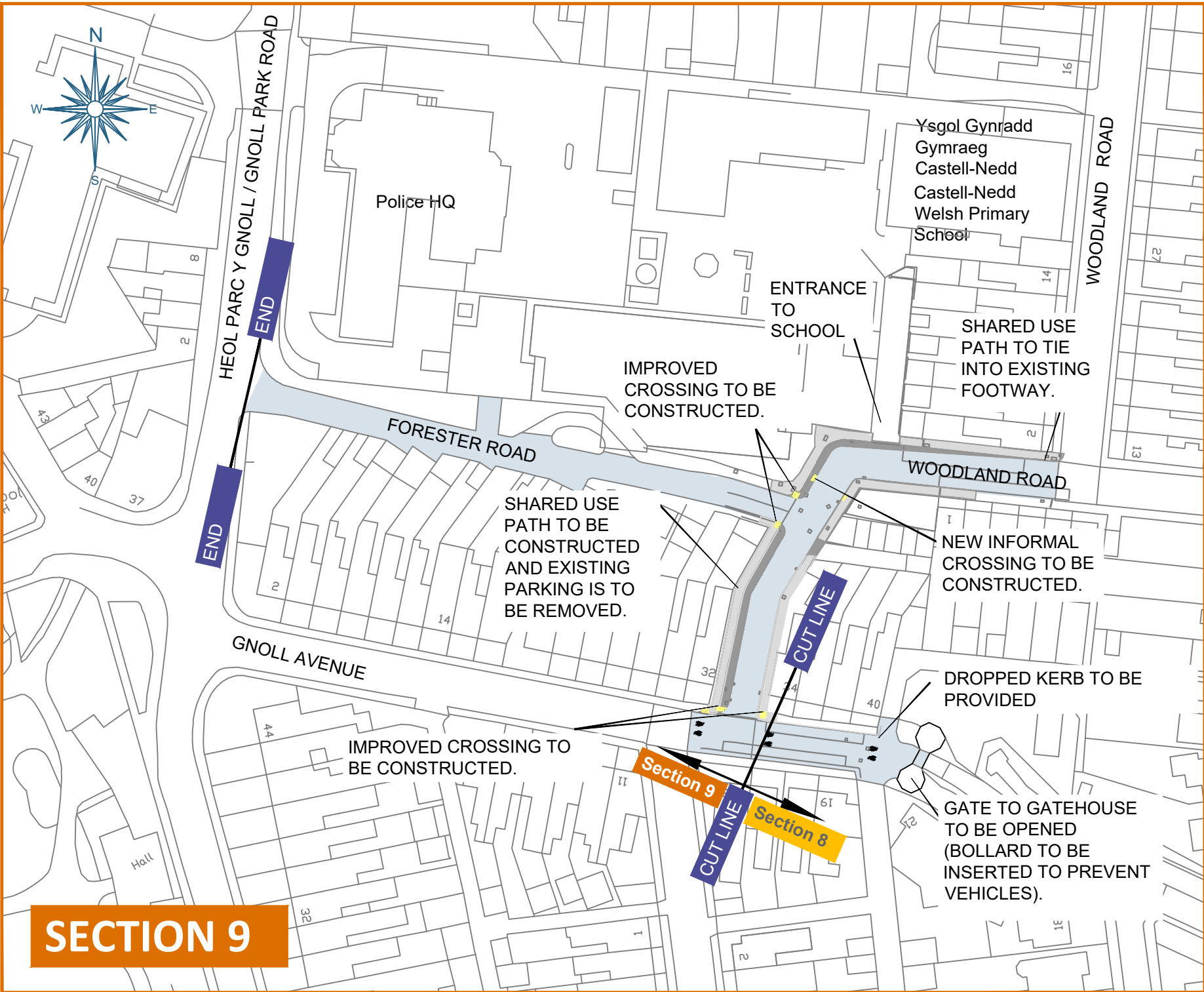

SECTION 9